

ECO BLAZE 2000 D/G

BLAZE 2000DG PARTS BREAKOUT REV 2

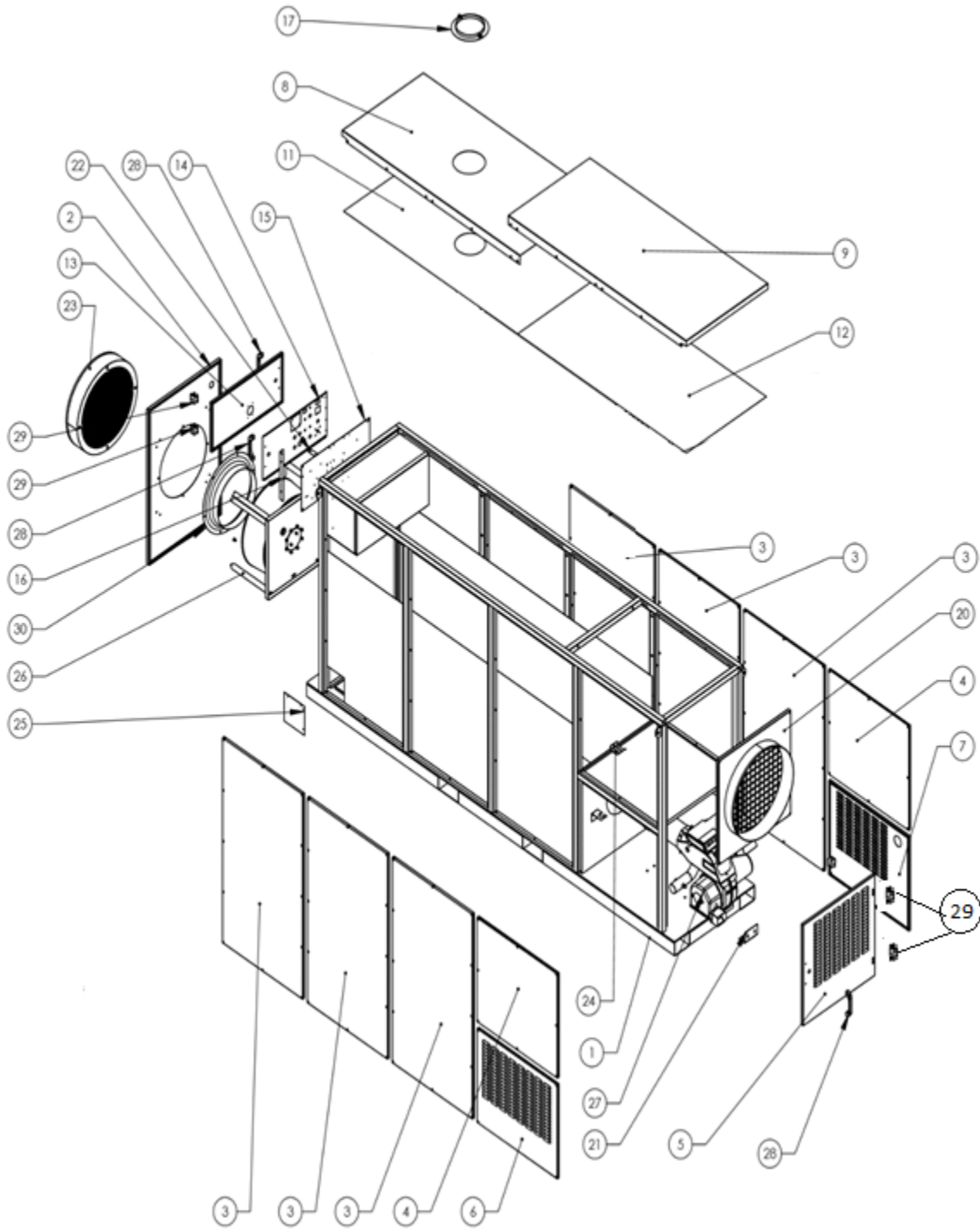

ECO BLAZE 2000 D/G

POSITION	PART NUMBER	DESCRIPTION	QTY
1	C80063	BLAZE 2000 FRAME WELDMENT	1
2	C80080/C80126	R FAN MOUNTING PLATE/E 560 FAN MOUNT PLATE	1
3	C80064	SIDE PANEL	6
4	C80065/ C80130/C80134	SIDE PANEL/24" SIDE SUPPLY PANEL/20" SIDE SUPPLY PANEL	2
5	C80066	LOUVERED BURNER ACCESS PANEL	1
6	C80067	LOUVERED PANEL	1
7	C80068	LOUVERED PANEL W/GAS TRAIN HOLE	1
8	C80069	TOP COVER W/ FLUE HOLE	1
9	C80070/ C80131/C80133	TOP COVER/TOP COVER W/ 24" SUPPLY PANEL/TOP COVER W/20" SUPPLY PANEL	1
11	C80072	TOP PANEL W/ FLUE HOLE	1
12	C80073	TOP PANEL	1
13	C80003	PANEL DOOR	1
14	C80020	CONTROL PANEL DOOR	1
15	C80019	CONTROL PANEL BACK PLATE	1
16	C80014	POST LATCH	1
17	C82002	SEAL RING WELDMENT 2000	2
20	C80076/ C80127/ C80128/ C80129/C80132	24" SUPPLY PANEL/20" SUPPLY PANEL/16" SUPPLY PANEL/4X 12" SUPPLY PANEL/PANEL COVER SUPPLY END	1
21	C80077	BURNER MOUNT BRKT	1
22	C80021	TILT SWITCH BRKT	1
23	C80006/ C82357	24" RETURN/SUPPLY RING / 20" RETURN RING	1
24	C80078	THERMOCOUPLE MOUNTING PLATE	1
25	C80079	CABLE THROUGH COVER	1
26	C80023/C70136	R FAN/E FAN 560 with sleeve	1
27	C80086/C80099	BLAZE 2000D BECKETT BURNER/BLAZE 2000G BECKETT BURNER	1
28	C70087	GRAB HANDLE	3
29	C70088/C70089	RIGHT SIDE HINGE/NUT PLATE FOR RIGHT SIDE HINGE	4
30	C70135	E FAN INLET CONE 560	1

ECO BLAZE 2000 D/G

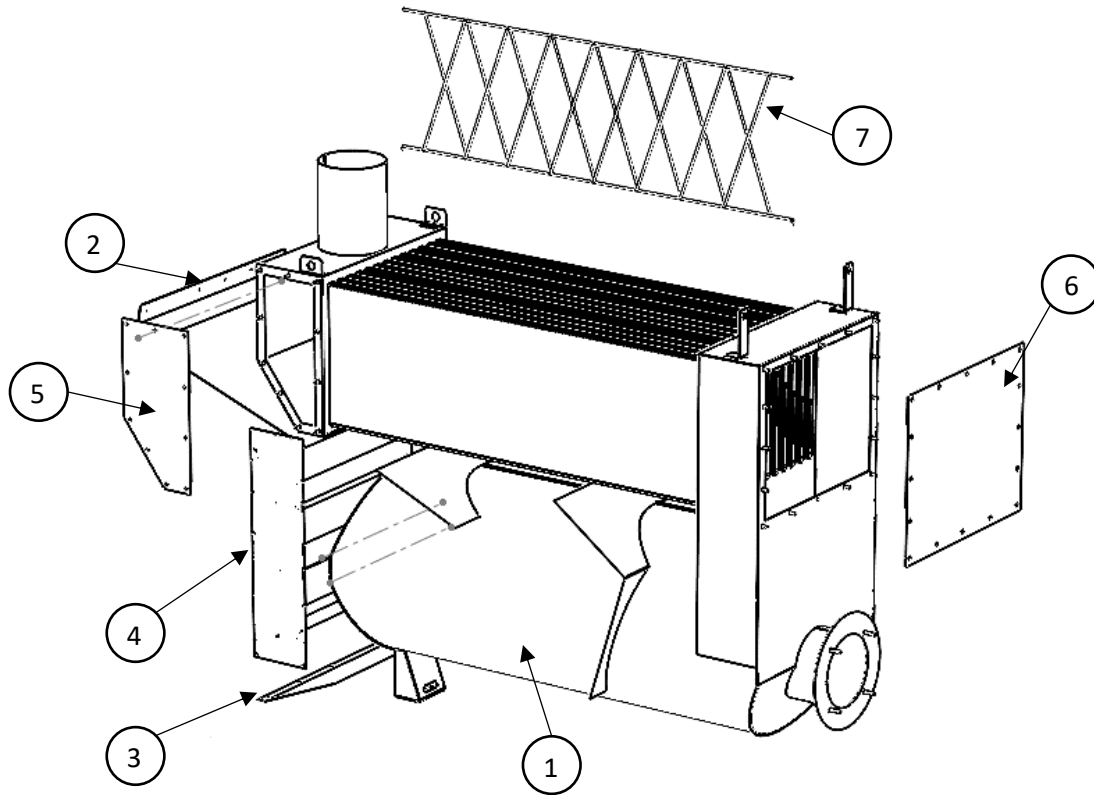

POSITION	PART NUMBER	DESCRIPTION	QTY
1	C80071	BLAZE 2000 HEATER	1
2	C80179	FRONT DEFLECTOR	1
3	C80178	DEFLECTOR	1
4	C80177	DEFLECTOR ASSEMBLY	1
5	C80074	HEATER SIDE COVER	1
6	C80075	HEATER FRONT COVER	1
7	C82004	BAFFLE	13

ECO BLAZE 2000 D/G

BLAZE 2000G GAS TRAIN BREAK OUT REV 1

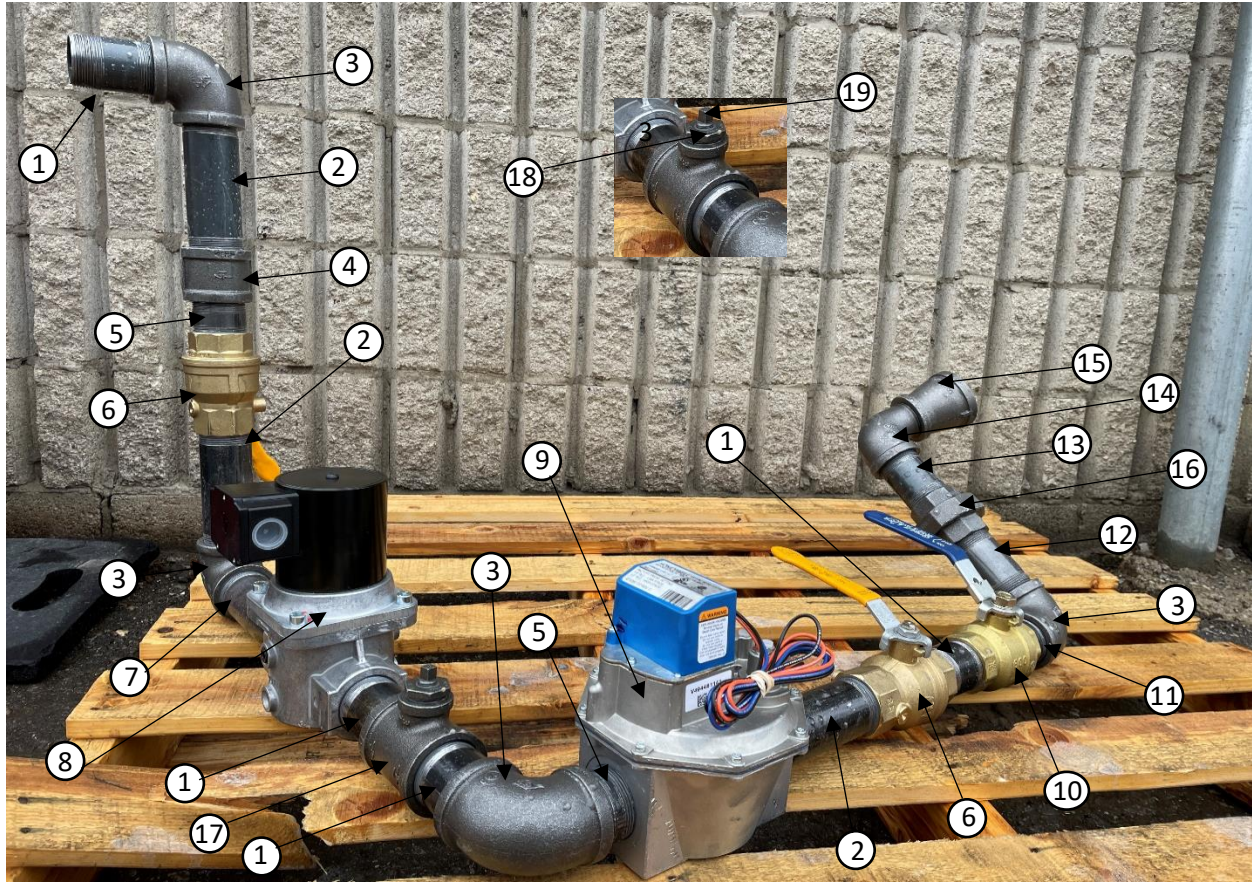

POSITION	PART #	DESCRIPTION	QTY
1	C80121	1.5" X 3" PIPE NIPPLE	4
2	C80117	1.5"X 6" PIPE NIPPLE	3
3	C80114	1.5" ELBOW	4
4	C80116	1.5" COUPLING	1
5	C80115	1.5" X 2" PIPE NIPPLE	2
6	C80118	1.5" BALL VALVE	2
7	C82226	1.5" X 7" PIPE NIPPLE	1
8	C80119	SAFETY VALVE, NC SOLENOID	1
9	C80120	VALVE, 2 STAGE REGULATOR	1
10	C80122	NG/LP EASY SWITCH OVER VALVE	1
11	C82232	1.5" X 2.5(L) PIPE NIPPLE	1
12	C82049	1.5" X 4(L) PIPE NIPPLE	1
13	C82233	1.5" X 3.5(L) PIPE NIPPLE	1
14	C80124	1.5" X 90° STREET ELBOW	1
15	C80125	2" X 1.5" REDUCER COUPLING	1
16	C80123	1.5" Union	1

ECO BLAZE 2000 D/G

17	C82050	1 1/2 x 1 1/2 x 3/4 T section	1
		Other parts	
18	C82051	3/4 to 1/4 reducer	1
19	C82227	1/4" Plug	1

C80099 BLAZE 2000G BECKETT BURNER BREAK OUT REV 1

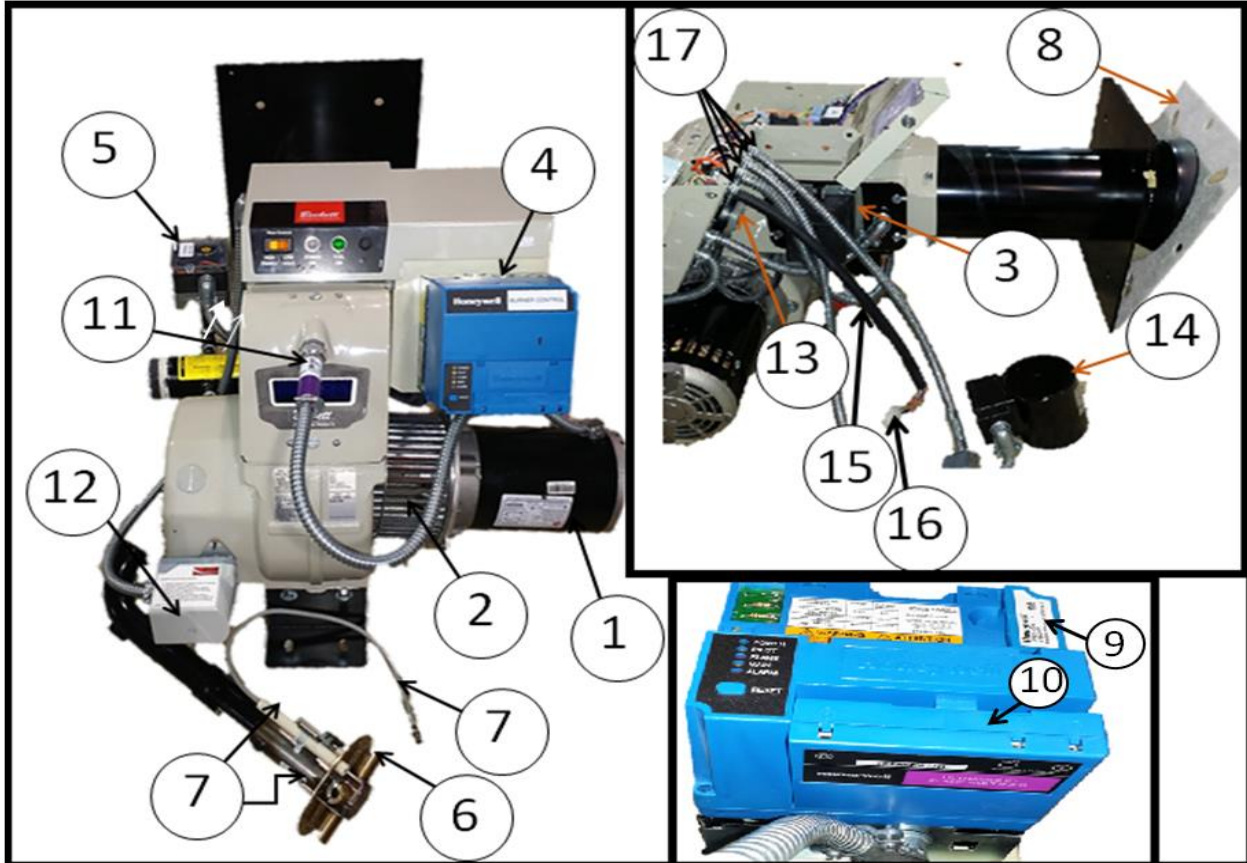

POSITION	PART #	DESCRIPTION	QTY
1	C80102	MOTOR	1
2	C80103	BLOWER	1
3	C80104	IGNITER	1
4	C80105	PRIMARY CONTROLLER	1
5	C50251	HIGH PRESSURE SWITCH	1
6	C80107	HEAD ASSEMBLY	1
7	C80108	ELECTRODE, GROUND AND CABLE	1
8	C80109	FLANGE GASKET	1
9	C80110	TIMER PURGE 60 SEC	1
10	C80111	UV AMPLIFIER	1
11	C80112	UV DETECTOR	1
12	C80113	DAMPER MOTOR	1
13	C80106	AIR PROVING SWITCH	1
14	C80119	SOLENOID	1

ECO BLAZE 2000 D/G

15	C50271	CABLE	1
16	C70110	PLUG, MALE 12 POLE	1
17	C50250	3/8" TWO SCREW CONNECTOR	4
	C80099	BLAZE 2000G BECKETT BURNER	1

C80086 BLAZE 2000D BECKETT BURNER BREAK OUT REV 1

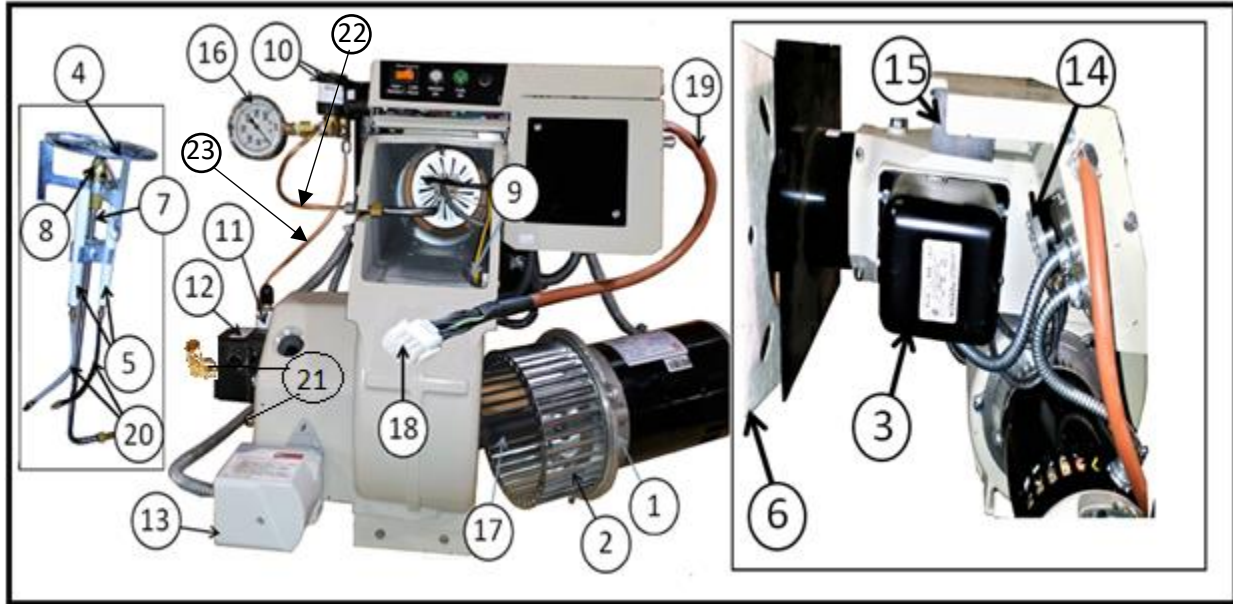

POSITION	PART #	DESCRIPTION	QTY
1	C80087	MOTOR	1
2	C80088	BLOWER	1
3	C80089	IGNITER	1
4	C80090	HEAD	1
5	C80091	ELECTRODES	1
6	C80092	FLANGE GASKET	1
7	C80093	NOZZLE LINE HEAD ASSEMBLY	1
8	C80039	NOZZLE, 5.5 X 60 B C/W MESH FILTER	1
9	C90076	CAD CELL	1
10	C40081	SOLENOID VALVE	2
11	C50272	VALVE ON FUEL PUMP	1
12	C80095	FUEL PUMP	1
13	C80096	DAMPER MOTOR	1
14	C80097	AIR PROVING SWITCH	1
15	C80098	TIMER	1
16	C80176	FUEL GAUGE	1
17	C50273	COUPLING	1
18	C70110	PLUG, MALE 12 POLE	1
19	C50274	CABLE	1
20	C50275	ELECTRODE CABLES	2
21	C90064	FLARE MALE 90-3/8 T X 1/4 MPT	2

ECO BLAZE 2000 D/G

22	C82275	8" Length Copper tube for 2000	
23	C82276	11" Length Copper tube for 2000	
	C80086	BLAZE 2000D BURNER	1

BLAZE 2000DG CONTROL PANEL BREAK OUT REV 1

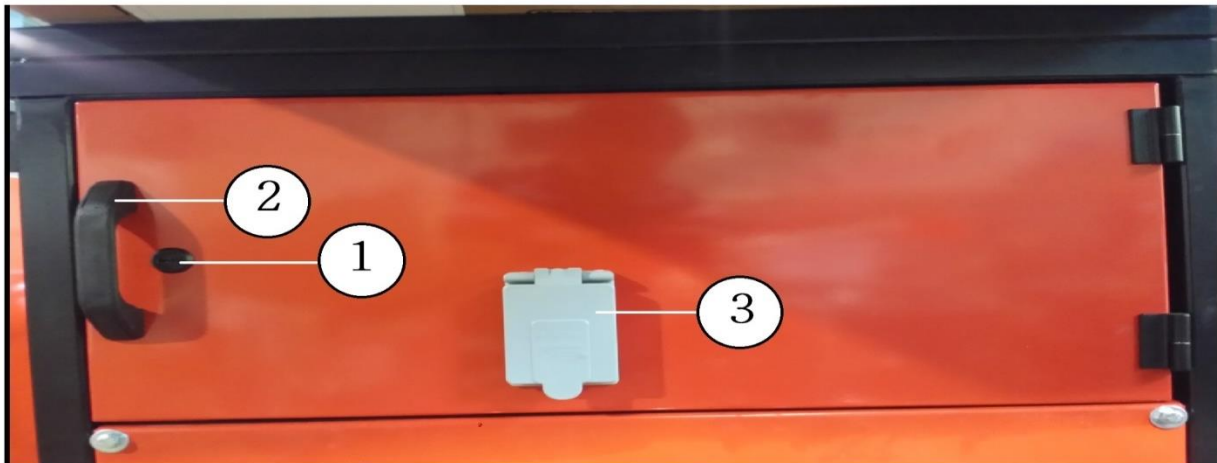
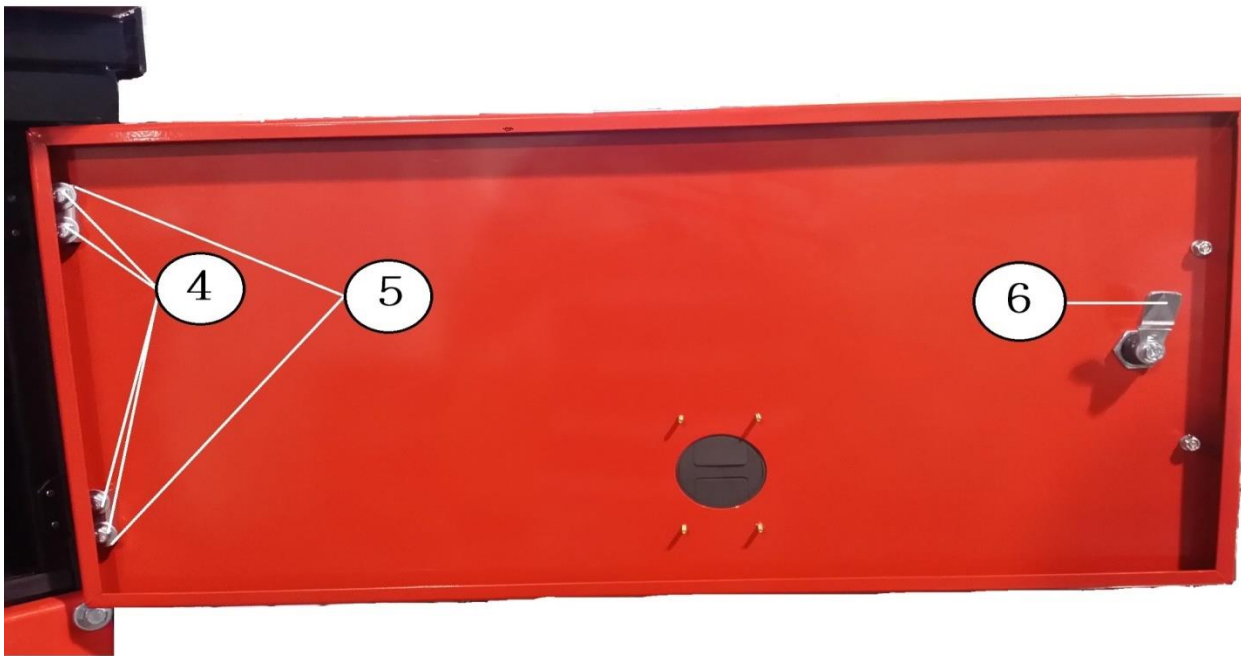

POSITION	PART #	DESCRIPTION	QTY
1	C70085	¼ TURN LATCH, WITH RUBBER WASHER & NUT	1
2	C70087	GRAB HANDLE	1
3	C70072	FLIP LID COVER HOUSING	1

ECO BLAZE 2000 D/G

4	C70088	RIGHT SIDE HINGE	2
5	C70089	NUT PLATE FOR RIGHT SIDE HINGE	2
6	C70084	LATCH,CAM,ZINC	1



Position	Part #	DESCRIPTION	QTY
1	C80033	ON/OFF YELLOW DISCONNECT SWITCH HANDLE	1
2	C70060	HOUR METER	1
3	C70065	SELECTOR SWITCH	3
4	C60122/	TEMPERATURE CONTROLLER	1
	C60122G	TEMPERATURE CONTROLLER – G Type	
5	C70066	RED ILLUMINATED PUSH BUTTON	1
6	C20023	TOGGLE SWITCH	1
7	C70064	SELECTOR SWITCH	2
8	C78889	DIGITAL PANEL MOUNTED VOLTMETER	1
9	C90029	OUTLET FOR PLUG	1
10	C90025	POWER ON INDICATOR LIGHT GREEN	1
11	C90027	BURNER ON INDICATOR LIGHT AMBER	1
12	C70070	INDICATOR LIGHT RED	1
13	C70023	PRIMARY CONTROLLER CUT-OUT COVER	1
14	C70085	¼ TURN LATCH, WITH RUBBER WASHER & NUT	1
15	C70087	GRAB HANDLE	1
16	C70063	TOGGLE	1

ECO BLAZE 2000 D/G

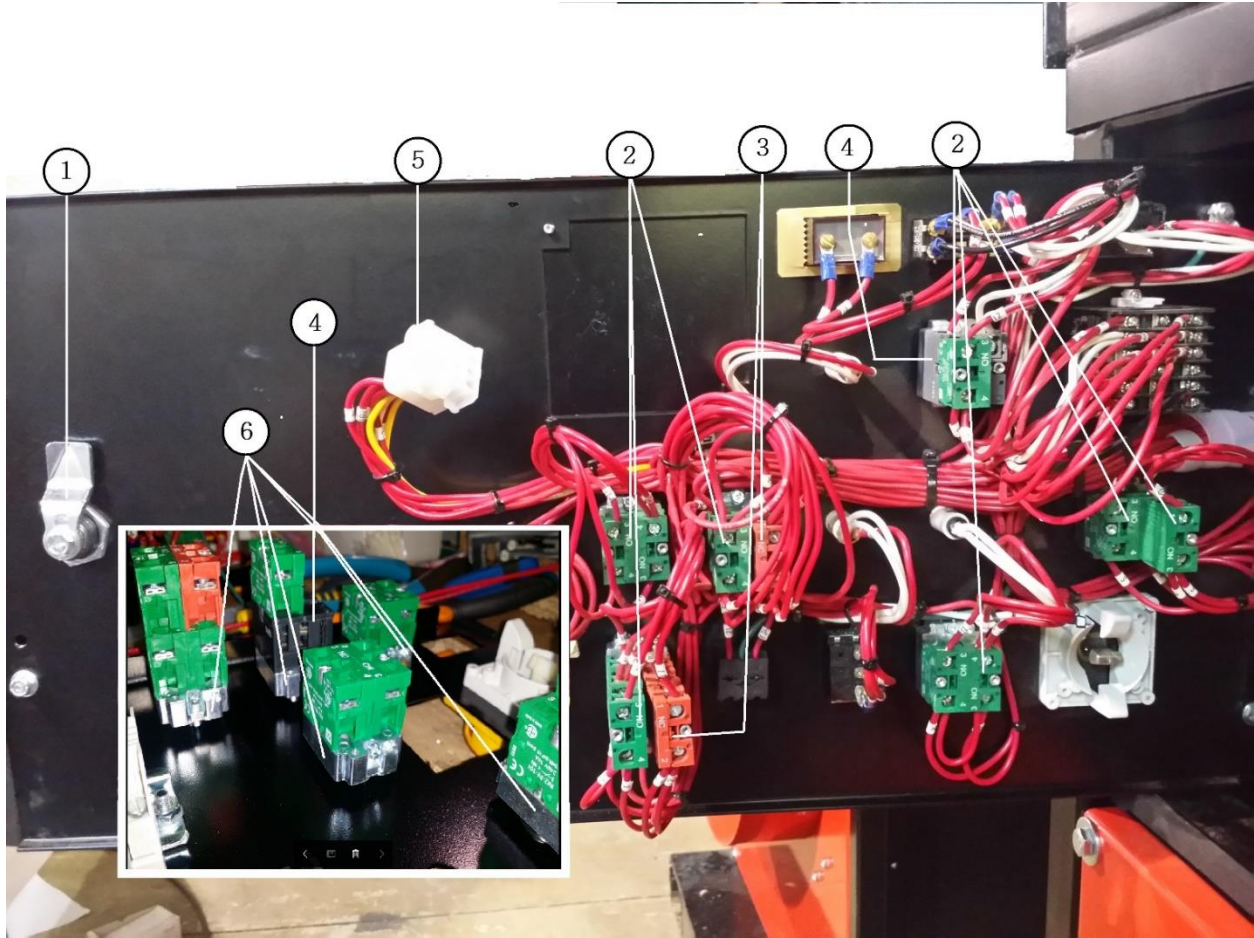

POSITION	PART #	DESCRIPTION	QTY
1	C70086	LATCH, CAM, ZINC	1
2	C70067	CONTACT BLOCK	13
3	C70071	CONTACT BLOCK	3
4	C70068	PUSH BUTTON WITH LATCH& LAMP	1
5	C70090	PLUG,FEMALE,12 POLE	1
6	C70069	FIXING COLLAR	6

ECO BLAZE 2000 D/G

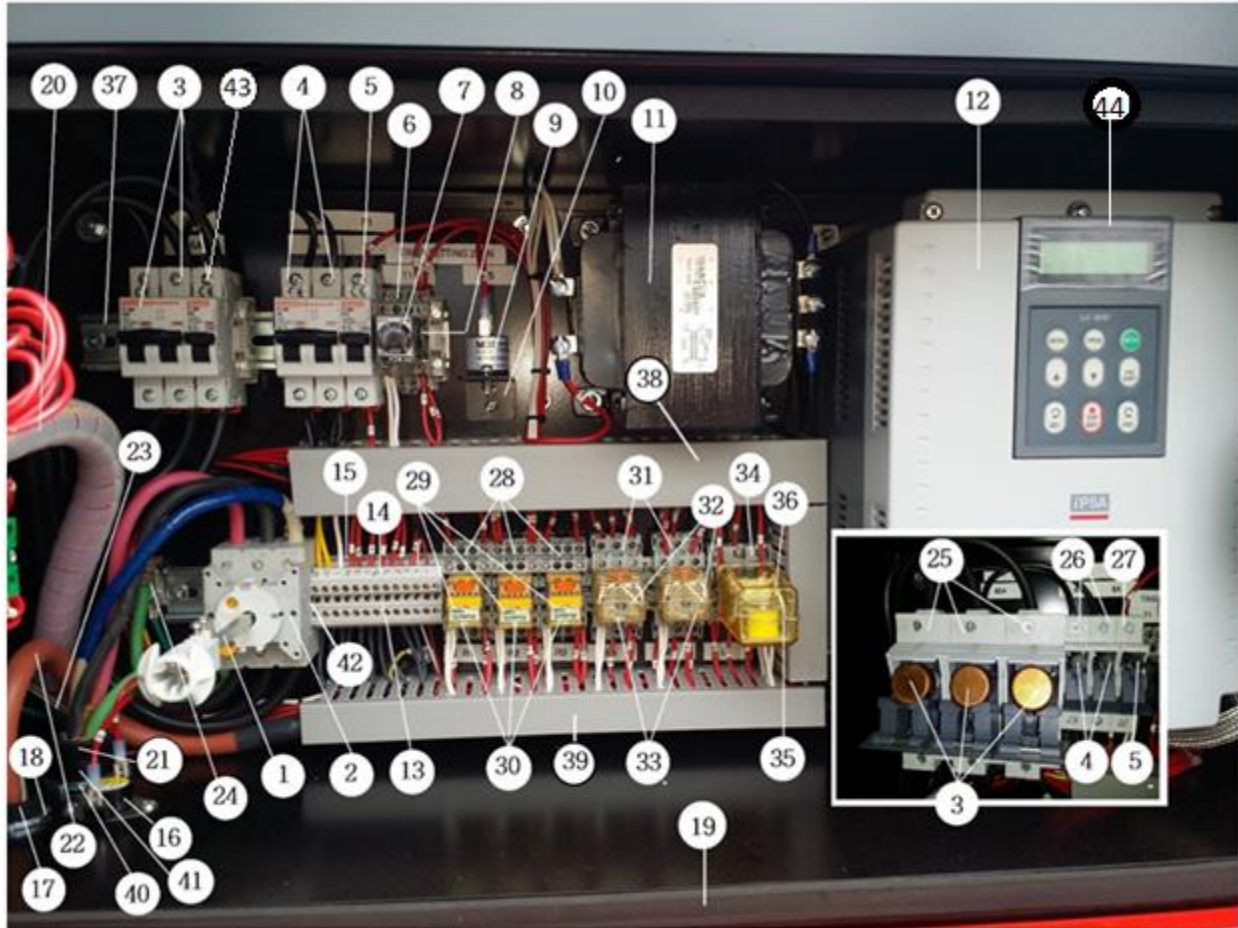

POSITION	PART #	DESCRIPTION	QTY
1	C70062	ON/OFF DISCONNECT SHAFT EXTENSION	1
2	C80034	ON/OFF DISCONNECT YELLOW SWITCH BASE 63 AMP	1
3	C50269 OR C80084	63 AMP BREAKER OR 45 AMP,600 VOLT TIME DELAY FUSE	1/3
4	C50276 OR C70034	16 AMP BREAKER OR 4 AMP 250 V TIME DELAY FUSE	1/2
5	C50277 OR C80085	6 AMP BREAKER OR 10 AMP 250 V TIME DELAY FUSE	1/1
6	C70042	RELAY BASE	1
7	C70044	TIMER	1
8	C70045	TIMER HOLD DOWN SPRING	2
9	C70052	TILT SWITCH	1
10	C80021	TILT SWITCH BRACKET	1
11	C80082	CONTROL TRANSFORMER	1
12	C80025	VFD	1
13	C40187	TERMINAL BLOCK	1
14	C70049	TERMINAL BLOCK BLANK MARKER,100 TAGS PER CARD	1
15	C70050	TERMINAL BLOCK RAIL	1

ECO BLAZE 2000 D/G

16	C80031	SNAP DISC FAN CONTROL	1
17	C70080	3/4" LIQUID TIGHT	2
18	C70081	3/4" NUT FOR LIQUID TIGHT	2
19	C70082	DOOR GASKET 1/4" X 1/2"	6.83 ft
20		FG TAPE	
21	C80032	AC POWER CAB TAR CABLE, 4 CONDUCTOR #6 GA.WIRE	1.1 m
22	C70078	16 AWG 12 COND HIGH TEMP CABLE	4.72 m
23	C50297	THERMOCOUPLE ASSEMBLY	1
24	C70051	GROUND LUG	1
25	C80027	FUSE HOLDER	1
26	C70031	FUSE HOLDER	1
27	C70032	FUSE HOLDER	1
28	C70042	RELAY BASE	3
29	C70043	RELAY HOLD DOWN SPRING, FOR 2 POLE RELAY	3
30	C70041	RELAY	3
31	C70039	RELAY BASE	2
32	C70040	RELAY HOLD DOWN SPRING, FOR 3 POLE RELAY	2
33	C70038	RELAY	2
34	C70036	RELAY BASE	1
35	C70037	RELAY HOLD DOWN SPRING, FOR LATCHING RELAY	1
36	C70035	LATCH RELAY	1
37	C70050	TERMINAL BLOCK RAIL	1
38	C80029	WIRE DUCT WITH COVER	1
39	C80030	WIRE DUCT WITH COVER	2
40	C80037	1 1/4" NUT FOR LIQUID TIGHT	1
41	C80036	1 1/4" LIQUID TIGHT	1
42	C40189	TERMINAL BLOCK END PLATE	1
43	C50270	1 POLE 63A BREAKER	1
44	C80148	KEYPAD FOR VFD	1

OPTIONAL PARTS

Part #	DESCRIPTION
C40188	TERMINAL BLOCK END STOP
C70075	3/4" FIRESLEEVE
C80035	1" FIRESLEEVE
C70079	2'X4' SHEETS OF INSULATION
C70083	DOOR GASKET 1/8" X 1/2"
C70091	PIN, FEMALE
C70092	PIN, MALE
C90086	GENISYS DISPLAY MODULE
C70110	MALE PLUG
C70090	PLUG, FEMALE, 12 POLE
C70091	PIN, FEMALE
C90023	FILTER
C90024	FILTER HEAD

ECO BLAZE 2000 D/G

7505P1515	PRIMARY CONTROLLER FOR 2000D
70115	1/4" CONVOLUTED (PLASTIC COVER FOR IGNITION WIRE)
C80100	(1) SOLENOID VALVE, (1) 2 STAGE VALVE, REGULATOR WITH (2) MANUAL SHUT OFF VALVES, PRESSURE SWITCH
C80101	1.5" SPLIT RING PIPE HANGAR
C70119	3/8" THREADED ROD
C70139	TOGGLE SWITCH 1 POLE, ON/ON
C70140	TOGGLE SWITCH
C70141	TEMPERATURE CONTROLLER HOUSING
C80176	High Pressure Gauge

BLAZE 2000DG DECAL KIT BREAK OUT REV 1

p/n C80081 COMPLETE KIT

p/n C80136

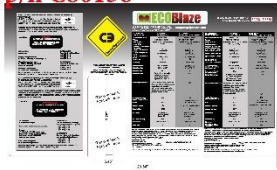

p/n C80137

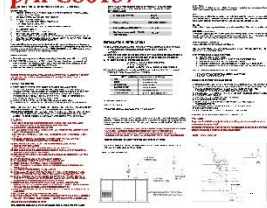

p/n C80138

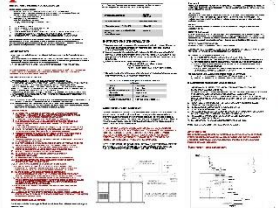

p/n C80139

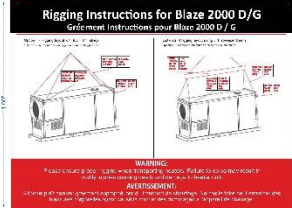

p/n C80140

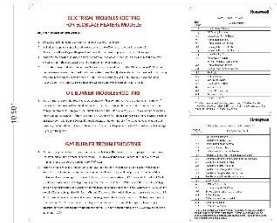

p/n C80141



p/n C80145



p/n C80146



p/n C80142



3.75"

p/n C80143



3.75"

p/n C80144



p/n C80147

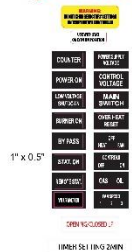

ECO BLAZE 2000 D/G

Part Number	DESCRIPTION
C80081	Blaze 2000DG Decal Kit
C80136	Serial Number (variable data)
C80137	English Instructions
C80138	French Instructions
C80139	Rigging Instructions
C80140	Quick set up guide
C80141	Warning - Large
C80142	Easy NG/LP Switch
C80143	WARNING - Small
C80144	Campo Logo
C80145	BLAZE 2000 DG
C80146	ECOBLAZE
C80147	Control Panel Decals