

DF1600

DF1600 PARTS BREAKOUT REV0

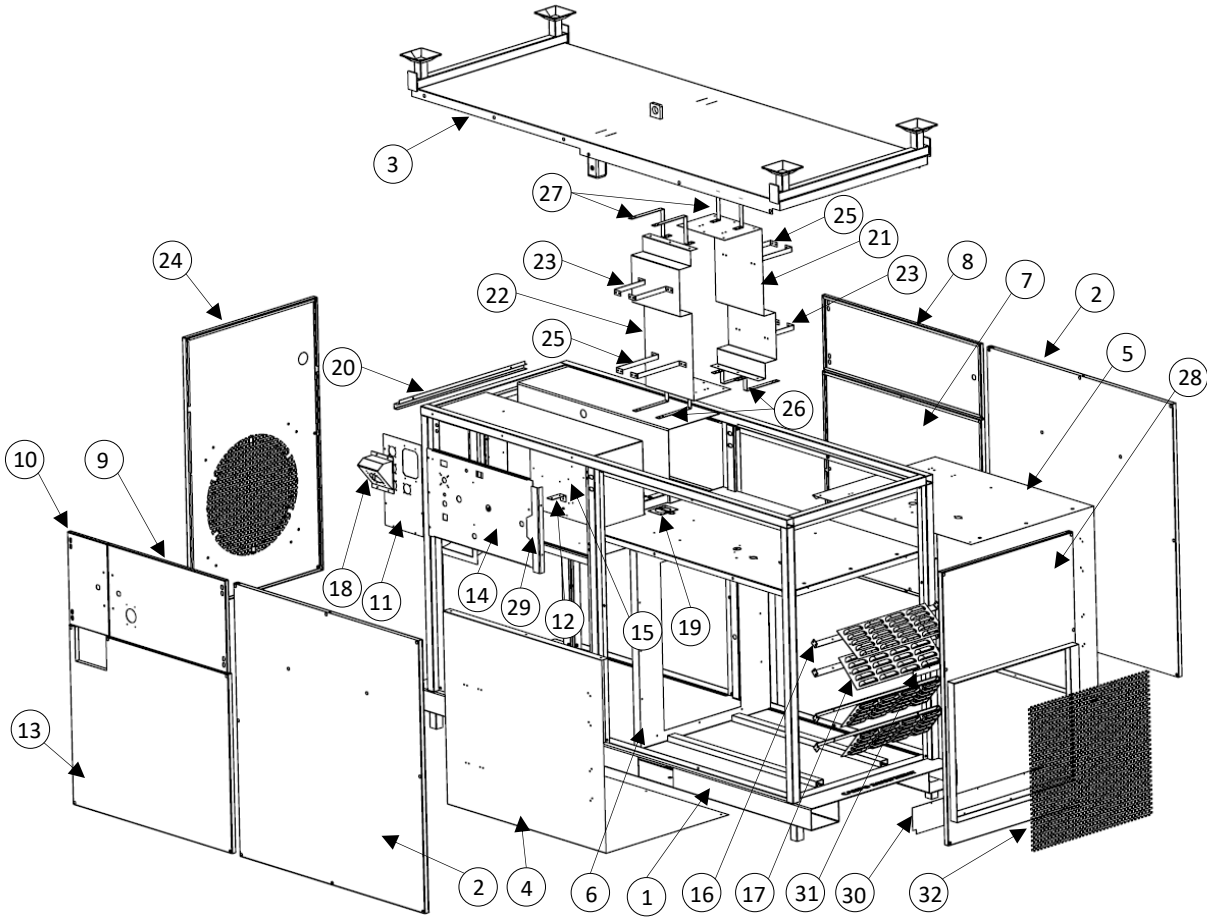

POSITION	PART NUMBER	DESCRIPTION	QTY
1	C82057	HEATER FRAME	1
2	C82058	PANEL	2
3	C82059	TOP COVER	1
4	C82060	BURNER SHROUD 1	1
5	C82061	BURNER SHROUD 2	1
6	C82062	BURNER SHROUD FRONT PLATE	1
7	C82063	PANEL	1
8	C82064	TRAIN DOOR	1
9	C82065	ELECTRIC DOOR RIGHT	1
10	C82066	ELEC DOOR LEFT	1
11	C82067	CAM LOCK PLATE	1
12	C80021	MOUNT BRKT (TILT SWITCH)	1
13	C82069	PANEL ASSEMBLY	1
14	C82070	ELECTRIC PANEL FRONT ASSEMBLY	1
15	C82071	CONTROL BACK PLATE ASSEMBLY	1

DF1600

16	C82072	Louver bar	4
17	C60190	Louver Plate	4
18	C82074	RECEPTACLE BOX	1
19	C82075	ADAPTER PLATE	2
20	C82076	WIRE CHANNEL	2
21	C82077	INNER BURNER SHROUD 1	1
22	C82078	INNER BURNER SHROUD 2	1
23	C82079	BURNER SHROUD BRACKET SMALL	4
24	C82080	R 500 FAN MOUNT ASSY	1
25	C82081	BURNER SHROUD BRACKET LONG	4
26	C82082	BURNER SHROUD BRACKET BOTTOM	4
27	C82083	BURNER SHROUD TOP BRACKET	4
28	C82084	SUPPLY PANEL RECTANGULAR ASSY	1
29	C82219	CORNER STOP	1
30	C82220	INSULATION BACK PANEL	1
31	C82221	INSULATION BACK PANEL TOP	1
32	C82222	1 1/2-16F EXPANDED METAL MESH SS	1
	C70137	R Fan 500 with sleeve	1
	C50218	CASTER	4



POSITION	PART#	DESCRIPTION	QTY
1	C70088	RIGHT SIDE HINGE	2
2	C70087	Grab Handle	1
3	C70085	¼ TURN LATCH, WITH RUBBER WASHER & NUT	1
4	C70072	Flip lid cover housing	1
5	C60119	LEFT SIDE HINGE	2

DF1600

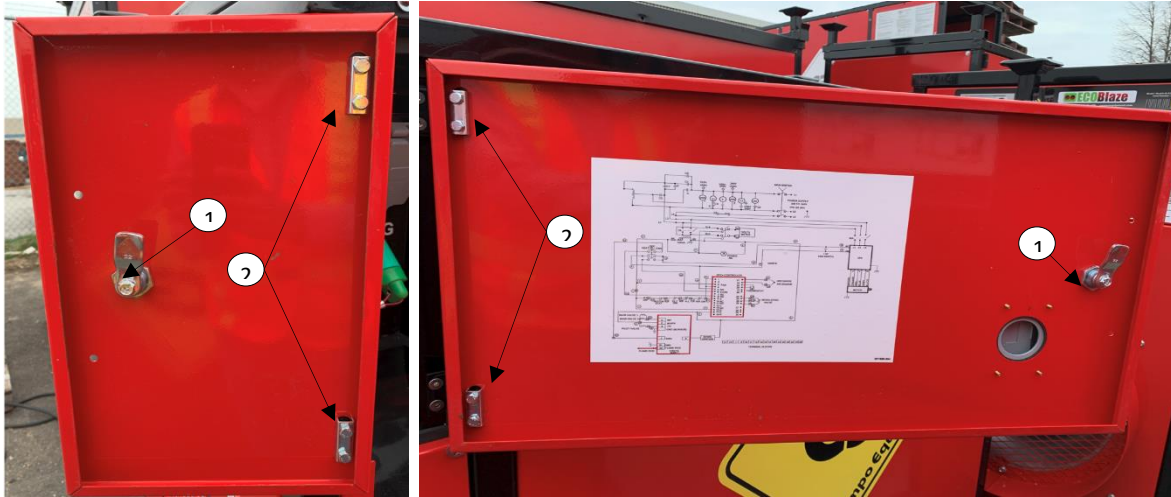

POSITION	PART#	DESCRIPTION	QTY
1	C70085	Latch, Cam	3
2	C70089	Nut Plate for Hinge	6

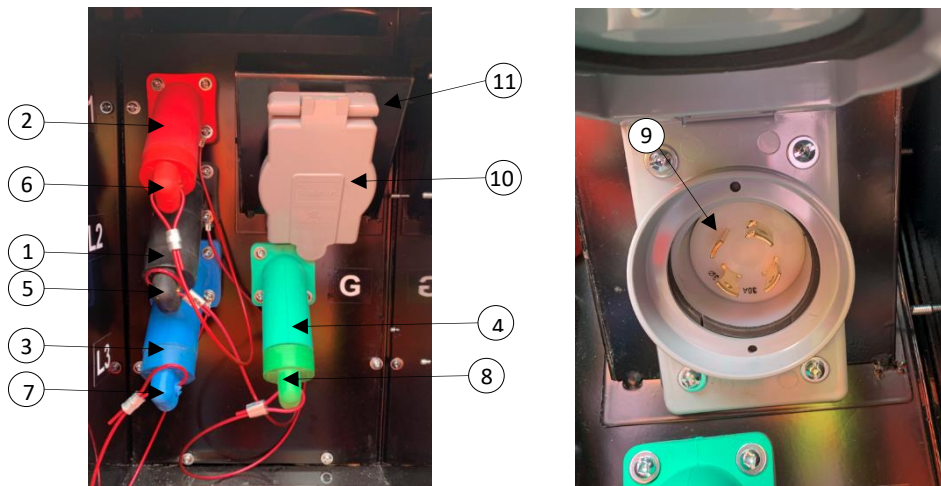

POSITION	PART#	DESCRIPTION	QTY
1	C50131	CAM LOCKS BLACK	1
2	C50132	CAM LOCKS RED	1
3	C50133	CAM LOCKS BLUE	1
4	C50134	CAM LOCKS GREEN	1
5	C82044	CAM LOCK CAPS BLK	1
6	C82045	CAM LOCK CAPS RED	1
7	C82046	CAM LOCK CAPS BLUE	1
8	C82047	CAM LOCK CAPS GREEN	1
9	C82038	MALE FLANGE INLET	1
10	C82396	FLIP LID COVER HOUSING FOR FLANGE INLET	1
11	C82074	RECEPTACLE BOX	1

DF1600



POSITION	PART#	DESCRIPTION	QTY
1	C80186	MAIN CONTROLLER	1
2	C82229	YELLOW/RED KNOB	1
3	C78889	DIGITAL PANEL MOUNTED VOLTMETER	1
4	C90025	POWER ON INDICATOR LIGHT GREEN	1
5	C90029	OUTLET FOR PLUG	1
6	C70066	RED ILLUMINATED PUSH BUTTON	1
7	C20023	TOGGLE SWITCH	1
8	C70064	3 POSITION SWITCH	1
9	C70060	HOUR METER	1
10	C70085	LATCH, CAM	1

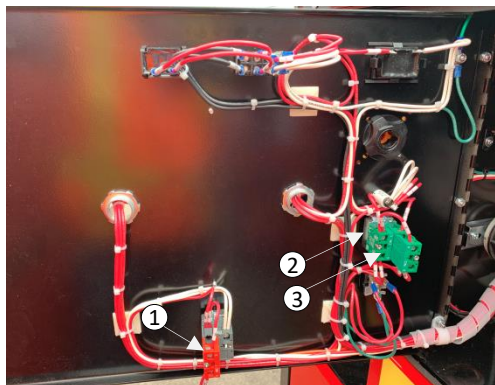

POSITION	PART#	DESCRIPTION	QTY
1	C82230	LAMP BASE	1
2	C70069	FIXING COLLAR	1
3	C70067	N.O. CONTACT BLOCK	1

DF1600

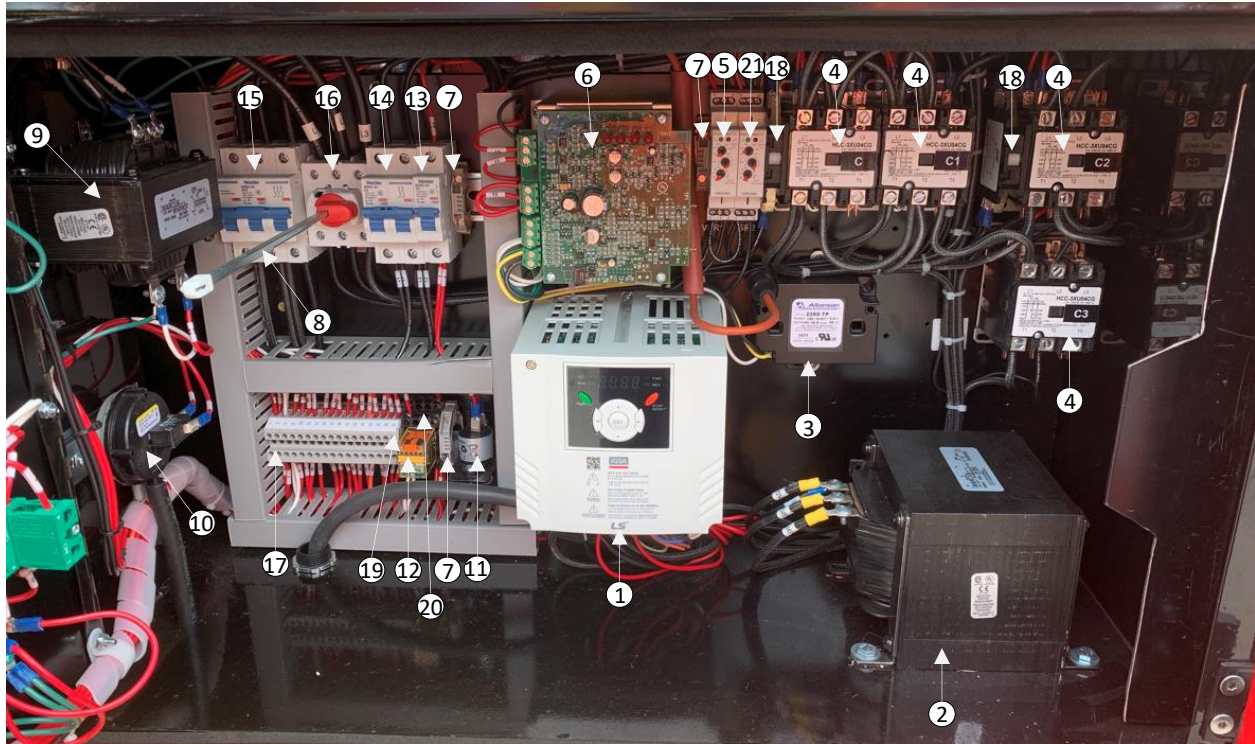

POSITION	PART#	DESCRIPTION	QTY
1	C70028	VFD	1
2	C82041	Transformer	1
3	C82043	GAS IGNITOR	1
4	C82040	Contactors	4
5	C82042-1	VSR1 RELAY 240A	1
6	C82036	Spark Controller	1
7	C70048	TERMINAL BLOCK END STOP	3
8	C82211	SHAFT	1
9	C80183	150VA 208/230V - 120V XTMR. TRANSFORMER	1
10	C50155	AIR SWITCH	1
11	C70052	TILT SWITCH	1
12	C70041	RELAY	1
13	C80182	4A 1P BREAKER	1
14	C80181	2A 2P BREAKER	1
15	C82224	3P 32A BREAKER	1
16	C82210	MAIN SWITCH BASE 40A	1
17	C70046	TERMINAL BLOCK	19
18	C50242	Aux. Contact N.O. 50A	2
19	C70047	TERMINAL BLOCK END PLATE	1
20	C70042	RELAY BASE	1
21	C82042-2	VSR2 RELAY 240A	1

DF1600

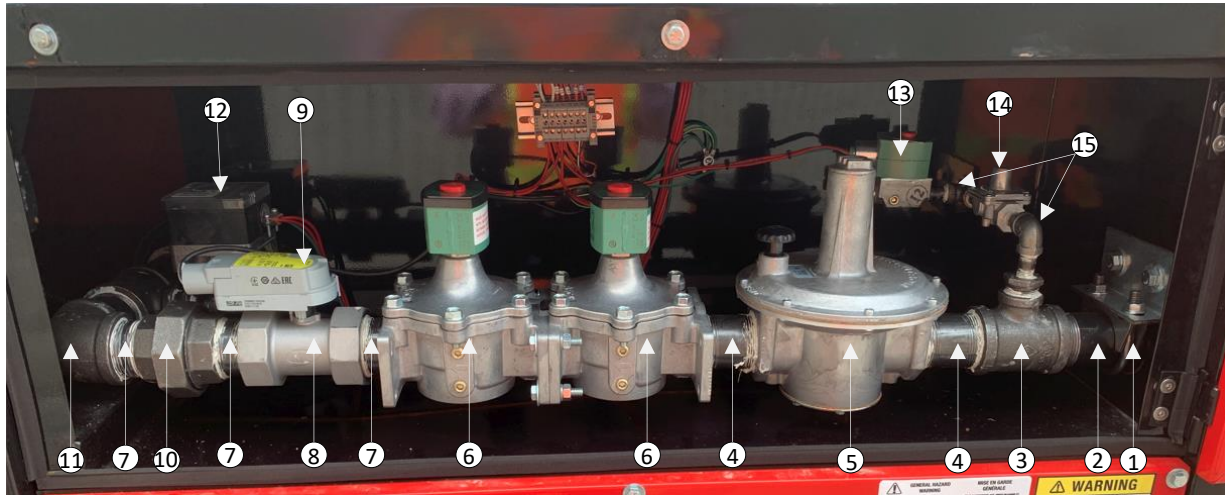

POSITION	PART#	DESCRIPTION	QTY
1	C82225	1 7/8 Muffler clamp	1
2	C82226	1 1/2x7" Nipple	1
3	C82050	1 1/2 x 1 1/2 x 3/4 T section	1
4	C80121	1.5" X 3" Pipe Nipple	4
5	C82054	Maxitrol Pressure Regulator	1
6	C82037	1 1/2" ASCO Solenoid Valve	2
7	C80115	1.5" X 2" Pipe Nipple	3
8	C82111	1 1/2" BUTTERFLY VALVE	1
9	C82112	2-10V MODULATING ACTUATOR	1
10	C80123	1.5" Union	1
11	C80114	1.5" Elbow	1
12	C50251	High Pressure Switch	1
13	C60136	1/4" ASCO Pilot Valve	1
14	C60137	1/4' Maxitrol pressure regulator	1
15	C82052	1/4 elbow	2
	Other parts		
	C60143	1" 1/2" X 1/4" Nipple	6
	C82051	3/4 to 1/4 reducer	2
	C82227	1/4" Plug	1
	C82231	1/4Fx1/4Fx1/4F T	1

DF1600

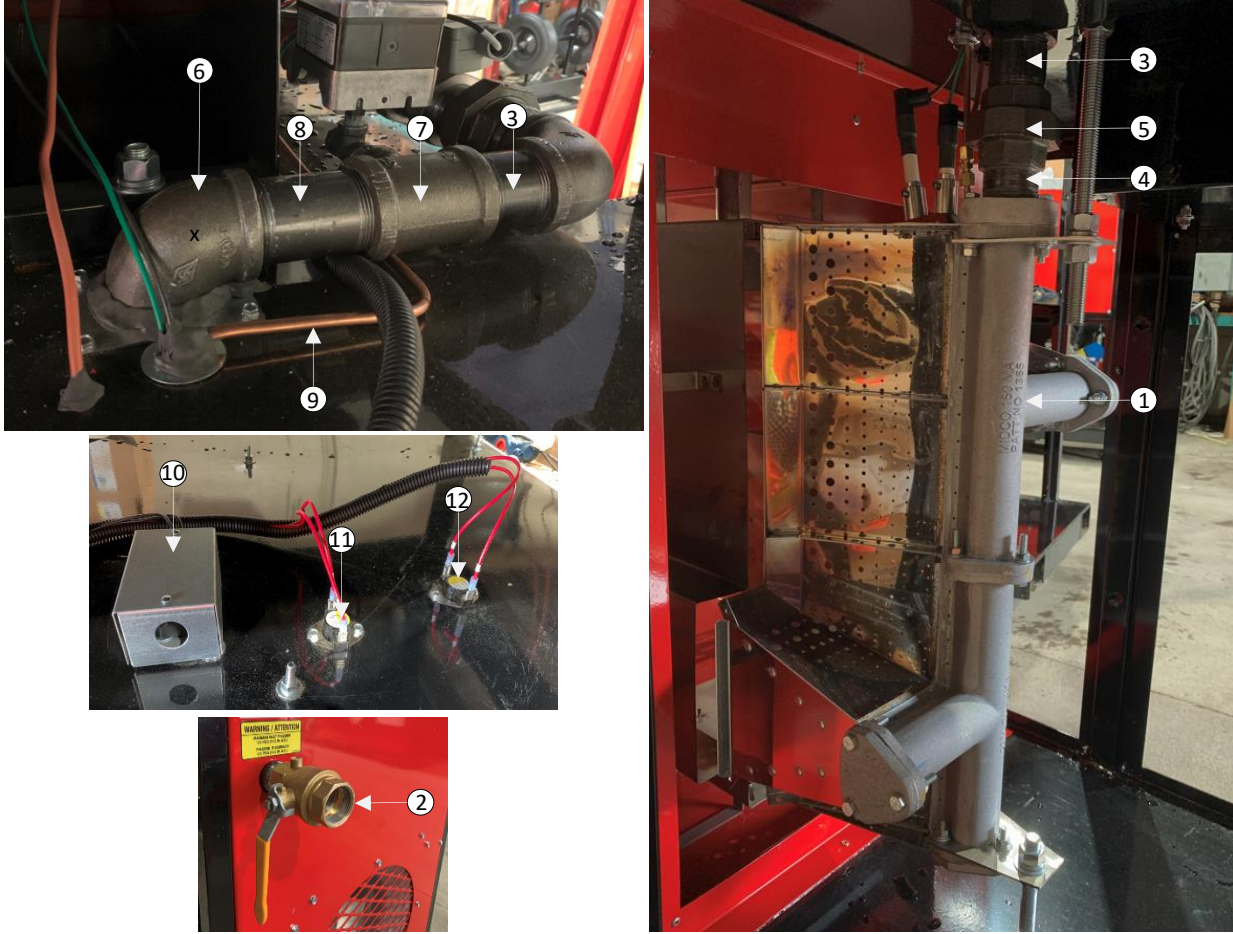

POSITION	PART#	DESCRIPTION	QTY
1	C82048	MIDCO BURNER 3FT.	1
2	C82053	1 1/2" MAIN VALVE	1
3	C80121	1.5" X 3" Pipe Nipple	2
4	C80115	1.5" X 2" Pipe Nipple	1
5	C80123	1.5" Union	1
6	C80114	1.5" Elbow	1
7	C82050	1 1/2 x 1 1/2 x 3/4 T section	1
8	C82049	1 1/2 x 4 nipple	1
9	C82228	46" Copper Tubing	1
10	C60139	Temperature Sensor c/w Stew	1
10	C80916	12" Discharge Air-tube	1
11	C80031	SNAP DISC FAN CONTROL	1
12	C90037	Fan Over-ride Switch	1

Other Parts

POSITION	PART#	DESCRIPTION	QTY
1	C82157	2nd Stage Regulator DF1600, DF2500 and DF4500	1

DF1600

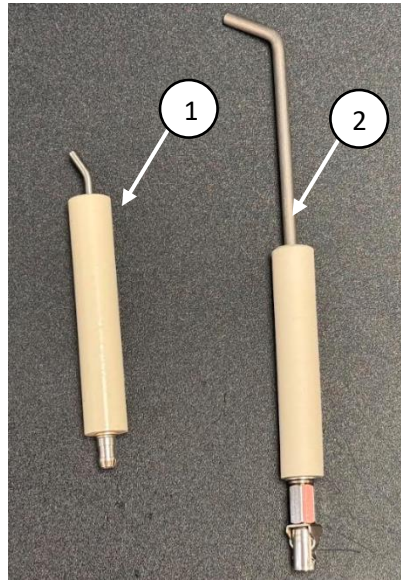

POSITION	PART#	DESCRIPTION	QTY
1	C82402	Pilot spark rod Igniter	1
2	C82403	DS Flame rod assembly	1

DF1600

DF1600 Decal Kit Break Out Rev0 (C82104)

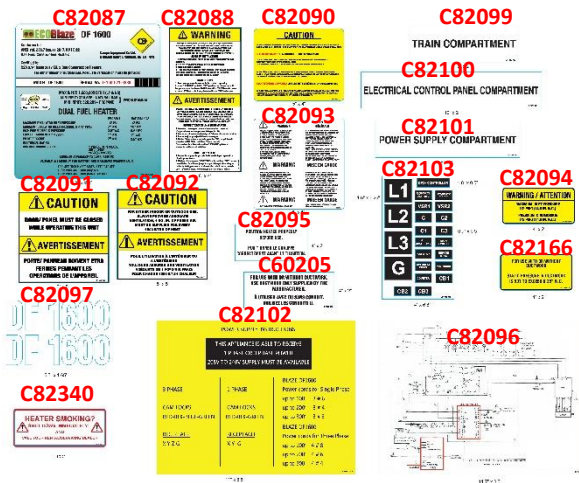

C82098

Blaze DF1600 Layout Sheet

PART#	DESCRIPTION	QTY
C82087	Serial Number (variable data)	1
C82088	Warning-Use with Propane or Natural Gas Only	1
C82090	Caution-supply cord	1
C82091	Caution-door panel-closed	1
C82092	caution- adequate ventilation	1
C82093	General Hazard Warning	1
C82094	Warning Max Inlet Pressure	1
C82095	Position Heater Properly before use	1
C82096	Wiring Diagram	1
C82097	DF 1600 logo	2
C82098	Decal-Campo Logo 16.50"	2
C82099	Decal - Train Compartment	1
C82100	Decal - Electrical Control Panel Compartment	1
C82101	Decal - Power Supply Compartment	1
C82102	Decal - Power Supply Instructions	1
C82103	Buttons	1
C82166	Decal - Ductwork	1
C82104	Complete Kit DF1600	1
C60205	Use With Or Without Ductwork	1
C82340	DECAL - HEATER SMOKING	1

DF1600